



9 Pound Mead, Corsham, SN13 9HA

£1,000 Per Month

- Two Bedroom Apartment
- Recently Decorated Throughout
- Kitchen/Lounge
- Allocated Parking Space
- Bathroom with Shower Over Bath
- Utility Cupboard

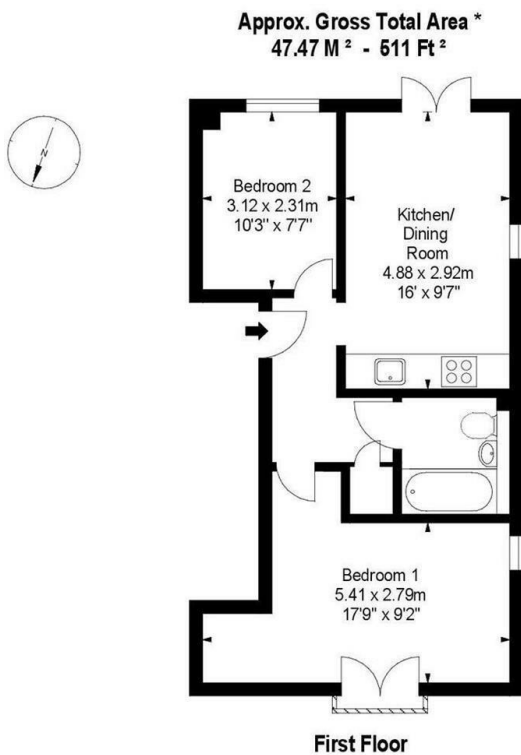
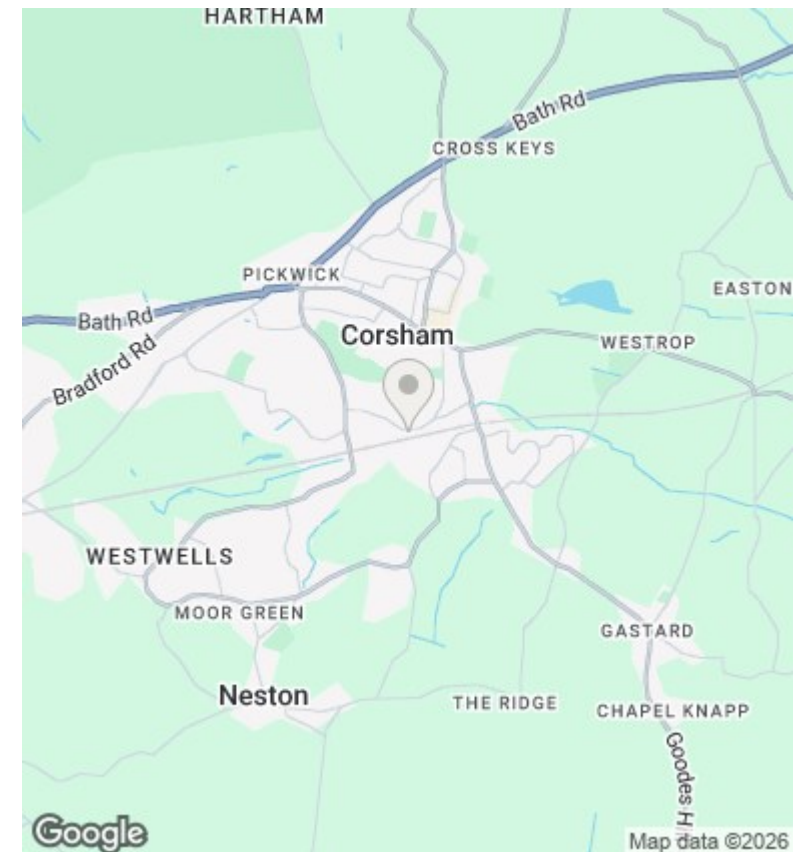

Illustration For Identification Purposes Only. Not To Scale

* As Defined by RICS - Code of Measuring Practice



Directions

Viewings

Viewings by arrangement only. Call 01249 466999 to make an appointment.

Council Tax Band

B

EPC Rating:

C

Energy Efficiency Rating		
	Current	Potential
<i>Very energy efficient - lower running costs</i>		
(92 plus) A		
(81-91) B		
(69-80) C	74	
(55-68) D		
(39-54) E		
(21-38) F		
(1-20) G		
<i>Not energy efficient - higher running costs</i>		
England & Wales	EU Directive 2002/91/EC	